

±21,400 SF
INDUSTRIAL
BUILDING
FOR LEASE

Class 6b
Status

Excellent
Access
to I-90

Institutionally
Owned and
Managed by:



605 BONNIE LANE

Elk Grove Village, IL 60007

[Property Website](#)



Specifications

- Building Size: ±21,400 SF
- Land Area: ±0.95 AC
- Office Size: ±3,500 SF
- Ceiling Height: 15' - 16'
- Loading: 2 Docks / 1 DID
- Power: 1600 Amps
- Parking: ±25 Cars
- Year Built: 1977
- Construction: Masonry
- Heating: Gas Fired Units
- **Lease Rate: Subject to Offer**

Highlights

- Under new ownership
- Class 6b status
- LED lighting
- Excellent access to I-90 and other major expressways
- Institutionally owned and managed



Ross Lehrman
Vice President
847.588.5671
ross.lehrman@transwestern.com

Joe Karmin, SIOR
Executive Vice President
847.588.5670
joe.karmin@transwestern.com

Justin Lerner, SIOR
Executive Vice President
847.588.5665
justin.lerner@transwestern.com

±21,400 SF
INDUSTRIAL
BUILDING
FOR LEASE

Class 6b
Status

Excellent
Access
to I-90

Institutionally
Owned and
Managed by:



605 BONNIE LANE

Elk Grove Village, IL 60007

[Property Website](#)

BUILDING LAYOUT

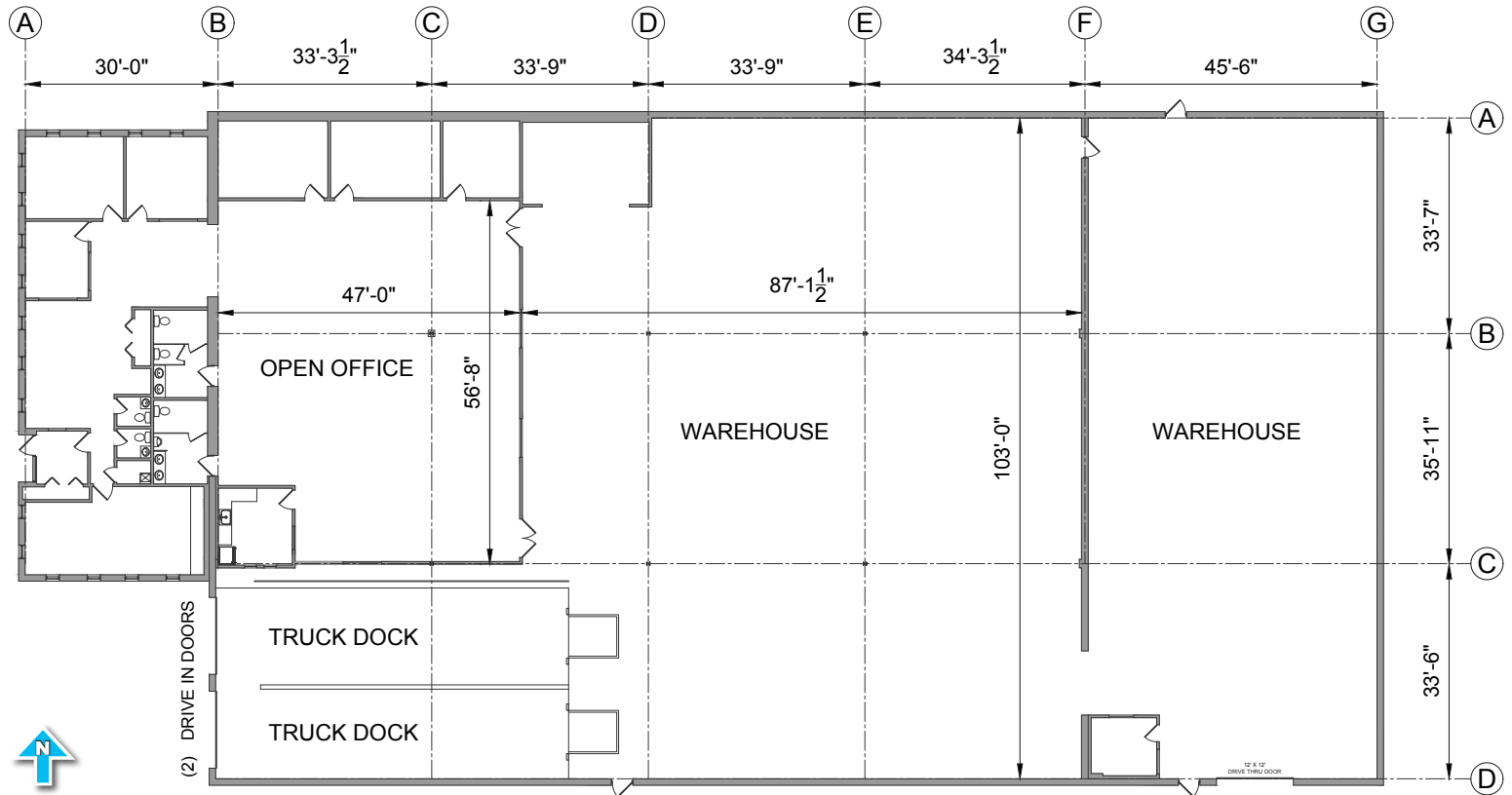

Ross Lehrman
Vice President
847.588.5671
ross.lehrman@transwestern.com

Joe Karmin, SIOR
Executive Vice President
847.588.5670
joe.karmin@transwestern.com

Justin Lerner, SIOR
Executive Vice President
847.588.5665
justin.lerner@transwestern.com

±21,400 SF
INDUSTRIAL
BUILDING
FOR LEASE

Class 6b
Status

Excellent
Access
to I-90

Institutionally
Owned and
Managed by:



605 BONNIE LANE

Elk Grove Village, IL 60007

[Property Website](#)

BUILDING RENDERINGS



Ross Lehrman
Vice President
847.588.5671
ross.lehrman@transwestern.com

Joe Karmin, SIOR
Executive Vice President
847.588.5670
joe.karmin@transwestern.com

Justin Lerner, SIOR
Executive Vice President
847.588.5665
justin.lerner@transwestern.com

The information provided herein was obtained from sources believed reliable; however, Transwestern makes no guarantees, warranties, or representations as to the completeness or accuracy thereof. The presentation of this information is submitted subject to errors, omissions, change of price or conditions, prior sale or lease, or withdrawal without notice. Copyright © 2023 Transwestern.