

3,500 - 3,700 SF

Industrial Property For Lease



BROWN
COMMERCIAL GROUP, INC.

350-360 LIVELY BLVD., ELK GROVE VILLAGE, IL 60007



LOCATION DESCRIPTION

Easy highway access via Rt. 72, Rt. 83, Rt. 53, I-90.

SPACES	LEASE RATE	SPACE SIZE
350	\$12.95 SF/yr	3,700 SF
352	\$12.95 SF/yr	3,500 SF
356	\$12.95 SF/yr	3,500 SF

PROPERTY OVERVIEW

- Smaller Industrial Units Available
- Approximately 10% Office Space
- 14' Clear Ceilings
- 200 Amp, 240 Volt, 3 Phase Power
- Available 10/1/23
- Lease Rate: \$12.95/SF Modified Gross

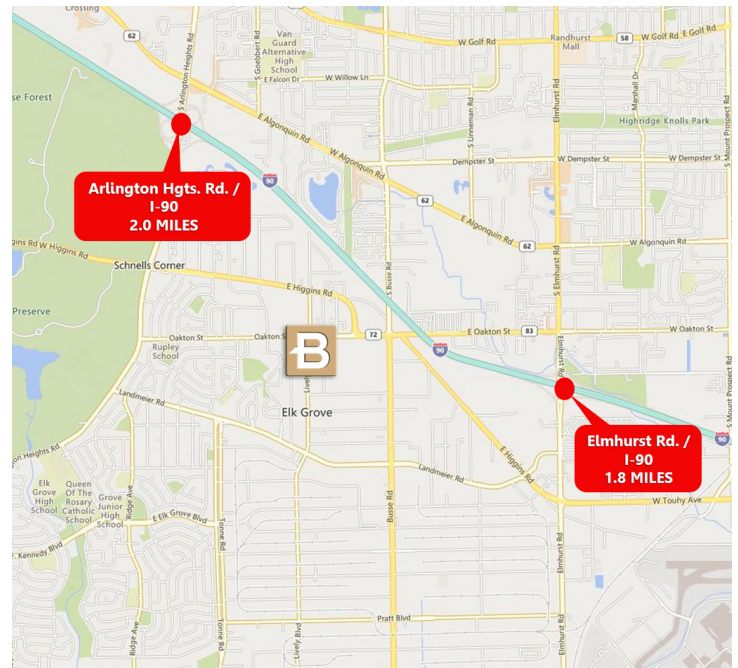

MASON HEZNER

847.758.9200 x306

MHEZNER@BROWNCOMMERCIALGROUP.COM

CANDACE SCURTO

847.758.9200 x311

CSCURTO@BROWNCOMMERCIALGROUP.COM

BROWNCOMMERCIALGROUP.COM // 1400 E. HIGGINS RD. SUITE A, ELK GROVE VILLAGE, IL 60007 // 847.758.9200

No warranties or representations is made as to the accuracy of the foregoing information. Terms and availability are subject to changes or withdrawal without notice

3,500 - 3,700 SF

Industrial Property For Lease



BROWN
COMMERCIAL GROUP, INC.

350-360 LIVELY BLVD., ELK GROVE VILLAGE, IL 60007



MASON HEZNER

847.758.9200 x306

MHEZNER@BROWNCOMMERCIALGROUP.COM

CANDACE SCURTO

847.758.9200 x311

CSCURTO@BROWNCOMMERCIALGROUP.COM

BROWNCOMMERCIALGROUP.COM // 1400 E. HIGGINS RD. SUITE A, ELK GROVE VILLAGE, IL 60007 // 847.758.9200

No warranties or representations is made as to the accuracy of the foregoing information. Terms and availability are subject to changes or withdrawal without notice

3,500 - 3,700 SF

Industrial Property For Lease



BROWN
COMMERCIAL GROUP, INC.

350-360 LIVELY BLVD., ELK GROVE VILLAGE, IL 60007

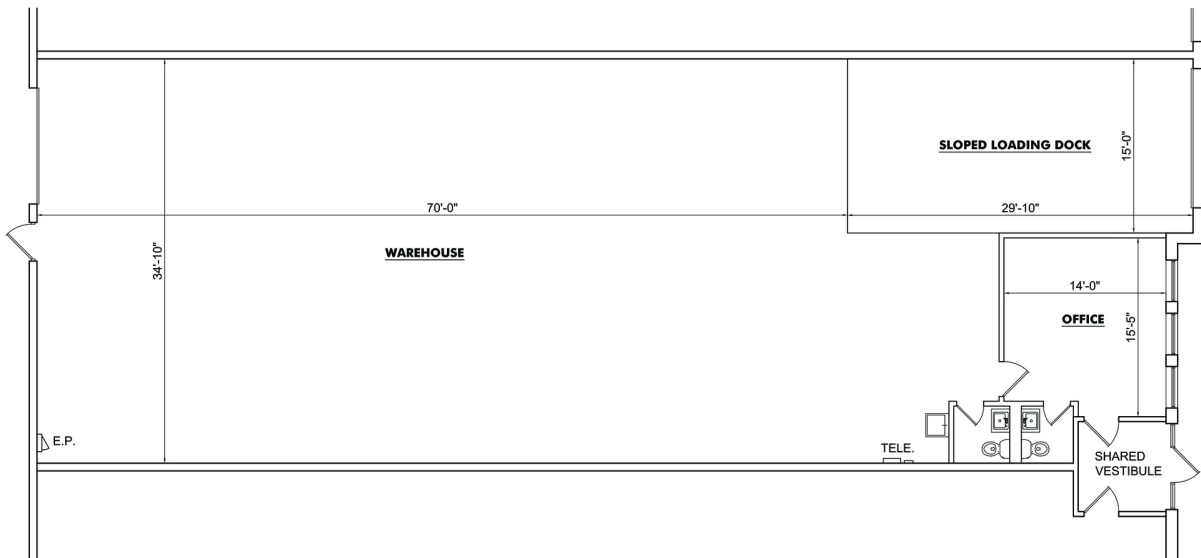
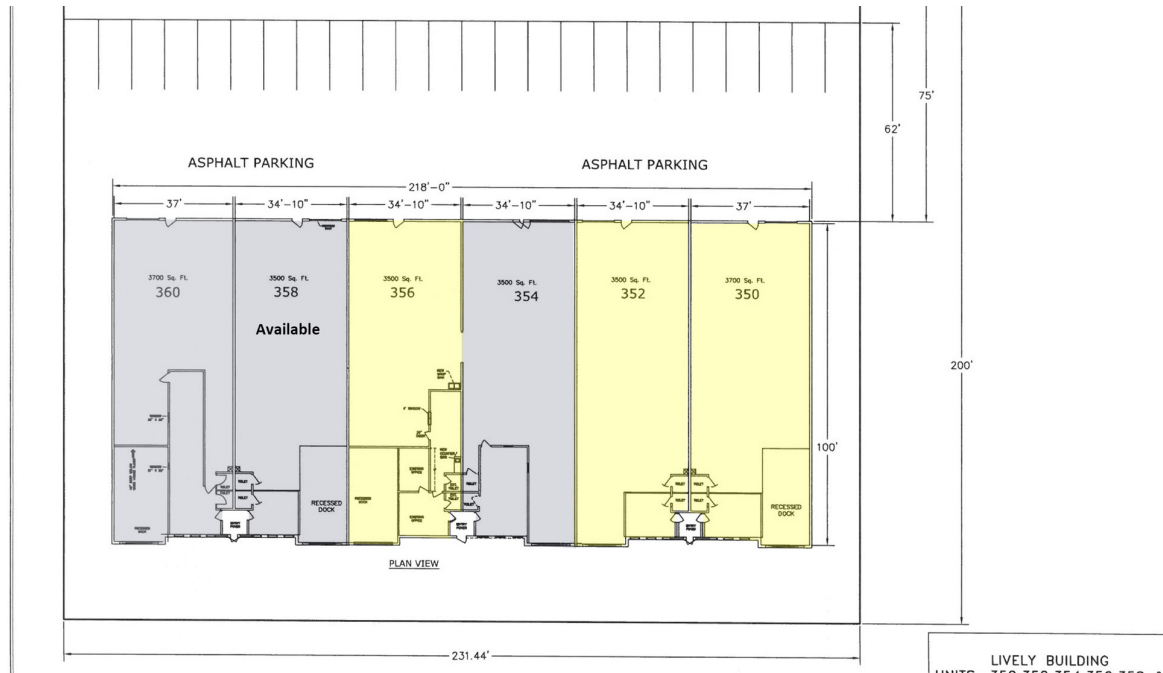

MASON HEZNER

847.758.9200 x306

MHEZNER@BROWNCOMMERCIALGROUP.COM

CANDACE SCURTO

847.758.9200 x311

CSCURTO@BROWNCOMMERCIALGROUP.COM

BROWNCOMMERCIALGROUP.COM // 1400 E. HIGGINS RD. SUITE A, ELK GROVE VILLAGE, IL 60007 // 847.758.9200

No warranties or representations is made as to the accuracy of the foregoing information. Terms and availability are subject to changes or withdrawal without notice