

1390 GATEWAY DRIVE | ELGIN, IL

FOR LEASE

Professionally Owned and Managed By:



AVAILABLE

UNITS 4, 5, & 6

Total Available:	Up to 23,040 Sq. Ft.
Office:	Up to 4,100 Sq. Ft.
Power:	400 Amp, 120/208V, 3-Phase
Ceiling Height:	20' Under Joists
Loading	3 Docks 3 Drive-in Doors
Taxes:	\$1.72 PSF
CAM:	\$2.50 PSF
Lease Rate:	Subject to Offer

BUILDING DETAILS

Total Building:	52,000 Sq. Ft.
Sprinklered:	Fully Sprinklered
Parking:	2 : 1,000

HIGHLIGHTS

- Located in Elgin Corporate Center
- Internet Service Provided by Comcast and AT&T
- Convenient Access to I-90 via Randall Road
- 30 Minutes to O'Hare

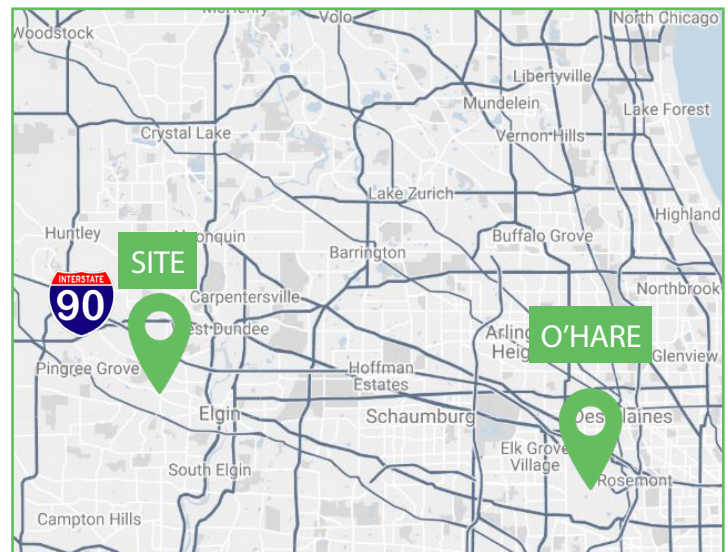

MATT GARLAND
312.339.9015
mgarland@cawleychicago.com

RAWLY LANTZ, SIOR
630.729.7944
rlantz@cawleychicago.com



1390 GATEWAY DRIVE | ELGIN, IL

UNIT 4, 5, & 6 UP TO 23,040 SQ. FT.

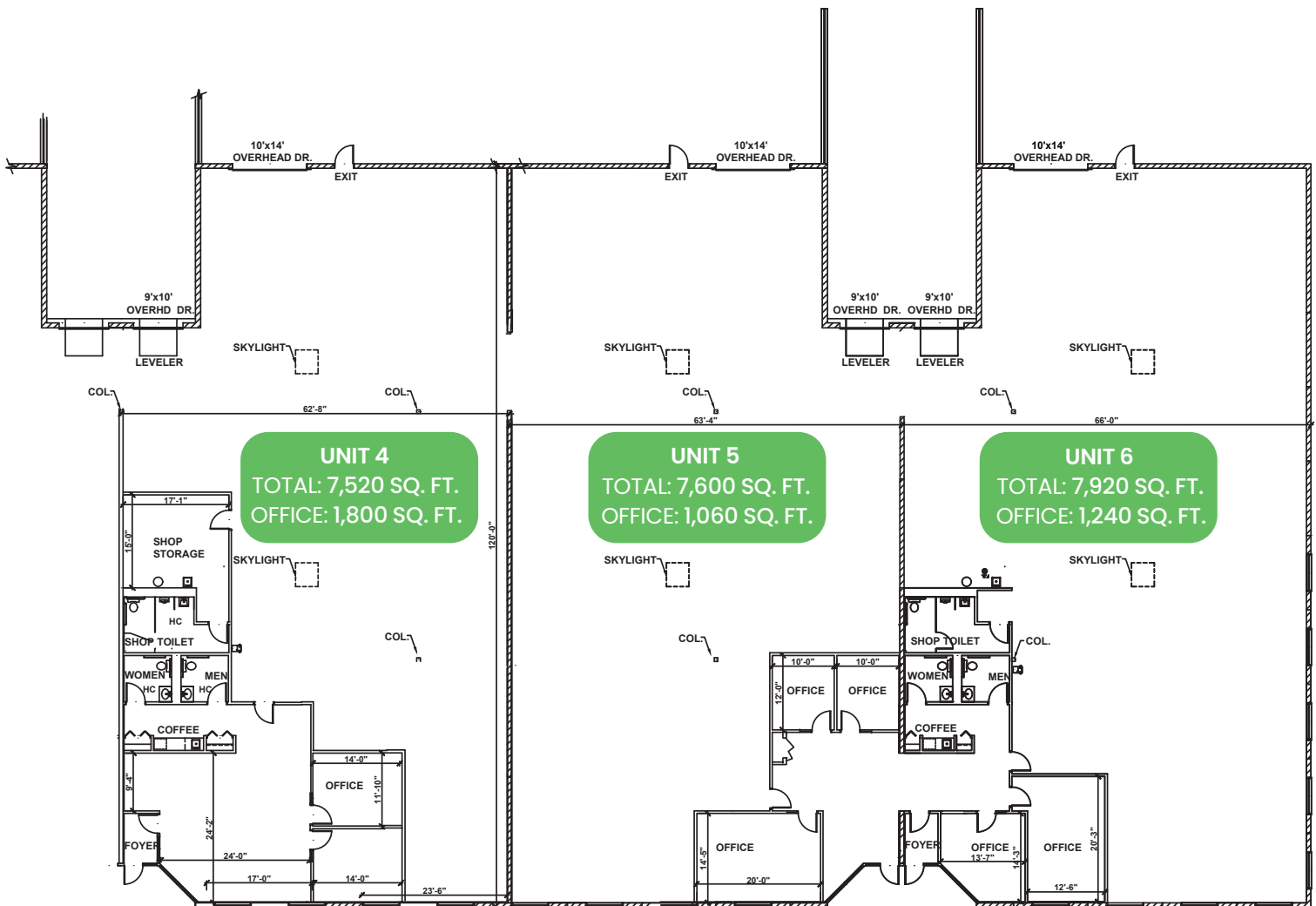

Professionally Owned and Managed By:



MATT GARLAND
312.339.9015
mgarland@cawleychicago.com

RAWLY LANTZ, SIOR
630.729.7944
rlantz@cawleychicago.com

