

Available
for Lease

29,070 SF
Industrial Warehouse

111 S Lombard Road

Addison, Illinois 60101

Professionally owned & managed by:



4 EXTERIOR DOCKS
& 3 DIDS



16'
CLEAR HEIGHT



LOCATED IN
DUPAGE COUNTY

PROPERTY HIGHLIGHTS

This 29,070 SF multi-tenant industrial property is located on 1.44 acres with immediate access to Interstate 355 via a four-way interchange.



ABUNDANT PARKING
FOR 40 CARS



QUICK ACCESS TO
I-355 VIA 4-WAY
INTERCHANGE



20 MINUTES TO
O'HARE AIRPORT

Contact

David Haigh, CCIM
+1 630 693 0649
dhaigh@hiffman.com

Nick Feczko
+1 630 693 0668
nfezko@hiffman.com

One Oakbrook Terrace
Suite 600
Oakbrook Terrace, Illinois 60181
+1 630 932 1234

hiffman.com

NO WARRANTY OR REPRESENTATION, EXPRESS OR IMPLIED, IS MADE AS TO THE ACCURACY OF THE INFORMATION CONTAINED HEREIN, AND THE SAME IS SUBMITTED SUBJECT TO ERRORS, OMISSIONS, CHANGE OF PRICE, RENTAL OR OTHER CONDITIONS, PRIOR SALE, LEASE OR FINANCING, OR WITHDRAWAL WITHOUT NOTICE, AND OF ANY SPECIAL LISTING CONDITIONS IMPOSED BY OUR PRINCIPALS NO WARRANTIES OR REPRESENTATIONS ARE MADE AS TO THE CONDITION OF THE PROPERTY OR ANY HAZARDS CONTAINED THEREIN ARE ANY TO BE IMPLIED.

	UNIT 3*	UNIT 4*
SIZE	2,817 SF	3,150 SF
OFFICE AREA	300 SF	300 SF
LOADING	1 Dock	1 Dock
POWER	3Phase 4 Wire 200A 120/240V	3Phase 4 Wire 200A 120/240V
AVAILABLE	30-Day Notice	Vacant
LEASE RATE	Subject to Offer	Subject to Offer



ADJACENT LEASES
UP TO 5,967 SF
AVAILABLE



LOCATED ON
1.44 ACRES



ABUNDANT SPACE
16' CLEAR HEIGHT



**EFFICIENT
LOADING AREA**
4 EXTERIOR DOCKS
& 3 DRIVE-IN-DOORS

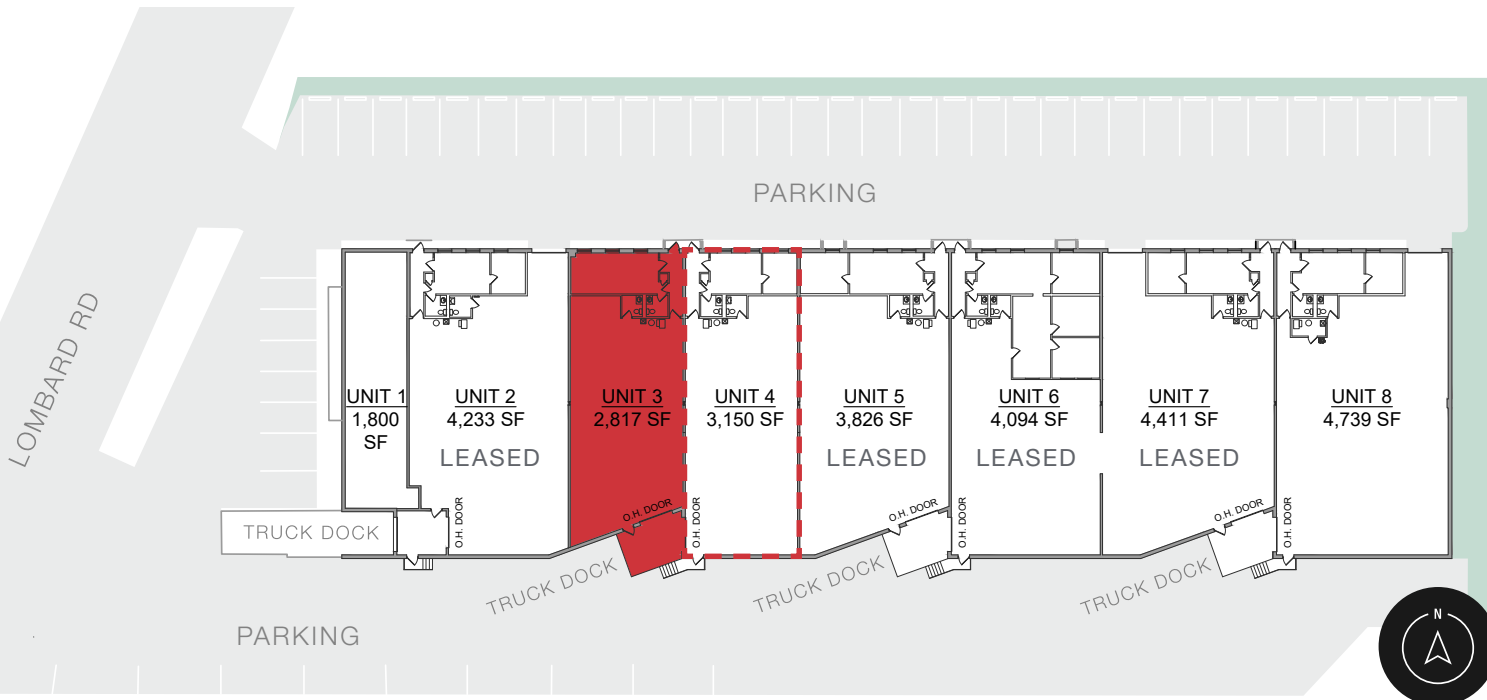

111 S LOMBARD RD, ADDISON, ILLINOIS | FOR LEASE

PROPERTY FEATURES

Built in 1985, this free standing facility offers 26,163 SF of industrial space, and 2,907 SF of office space available for lease.

29,070 SF
Free Standing
Warehouse

Pictured: Unit 3 Make-Ready Work Complete



111 S LOMBARD RD, ADDISON, ILLINOIS | FOR LEASE

111 S LOMBARD ROAD

Conveniently located in the Central DuPage submarket. This location provides quick access to Rohlwing Rd, Fullerton Ave and Army Trail Blvd.



111 S LOMBARD ROAD

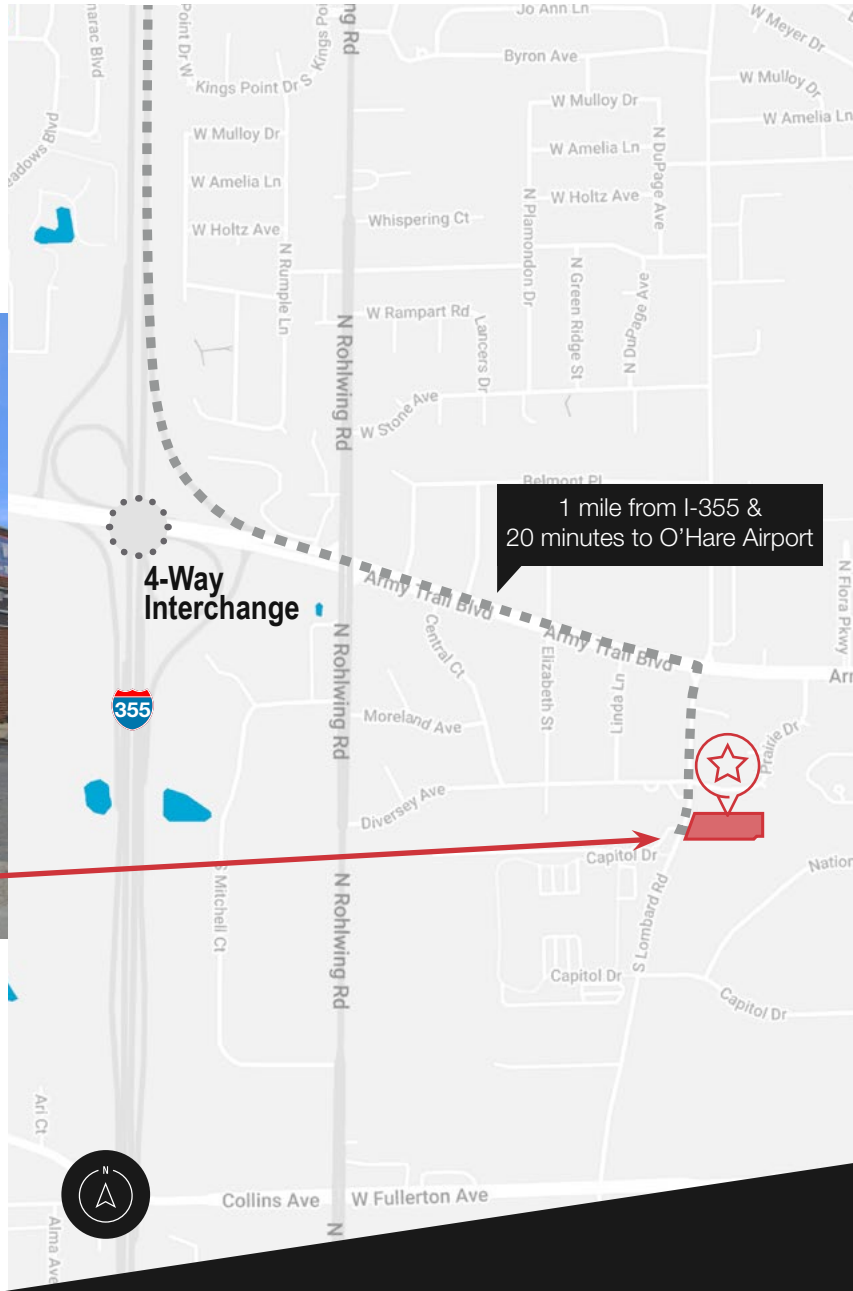

UP TO 5,967 SF AVAILABLE



4 EXTERIOR DOCKS & 3 DIDS



ABUNDANT PARKING FOR 40 CARS



1 MILE FROM I-355 HIGHWAY ACCESS



LOCATED IN DUPAGE COUNTY



CALL A NAI HIFFMAN BROKER TODAY!

David Haigh, CCIM

+1 630 693 0649
dhaigh@hiffman.com

Nick Feczko

+1 630 693 0668
nfezko@hiffman.com



One Oakbrook Terrace
Suite 600
Oakbrook Terrace, Illinois 60181
+1 630 932 1234

hiffman.com